

Αρχιτεκτονική εσωτερικών χώρων IV

Το οργανόγραμμα

Διδάσκοντες : Μανώλης Αναστασάκης, Νίκος Μπόμπολος (nbobolos@uniwa.gr)

Το κτιριολογικό πρόγραμμα

Παράδειγμα για εφαρμογή: κατοικία για τετραμελή οικογένεια

Ζευγάρι με δύο παιδιά → Τρία υπνοδωμάτια

Απαιτήσεις-προϋποθέσεις:

- Ένα καθιστικό-τραπεζαρία
- Κουζίνα
- Τουαλέτα στους χώρους υποδοχής
- Κύριο υπνοδωμάτιο με λουτρό.
- Δύο παιδικά υπνοδωμάτια με το λουτρό τους και μικρό καθιστικό.
- Η κατοικία θα αποτελείται από δύο επίπεδα (ισόγειο, όροφος).

α/α	Χώρος	Εμβαδόν	Παρατηρήσεις
1	Είσοδος-Προθάλαμος	10 m ²	
2	Καθιστικό-τραπεζαρία	30 m ²	
3	Κουζίνα	10 m ²	
4	Τουαλέτα χώρων υποδοχής (WC)	2 m ²	
5	Κύριο υπνοδωμάτιο με λουτρό	20 m ²	
6	Παιδικό υπνοδωμάτιο	12 m ²	
7	Παιδικό υπνοδωμάτιο	12 m ²	
8	Ιδιαίτερο καθιστικό	10 m ²	
9	Λουτρό	5 m ²	
	Σύνολο καθαρών επιφανειών	111 m²	
	Εμβαδόν χώρων κυκλοφορίας 20%	22 m ²	
	Εμβαδόν τοίχων 20%	22 m ²	
	Συνολικό (μικτό) εμβαδόν κτιρίου	155 m²	

Το οργανόγραμμα (ή λειτουργικό διάγραμμα)

- Στο οργανόγραμμα απεικονίζουμε τους χώρους σχηματικά (π.χ. με κύκλους ή ορθογώνια), τα μεγέθη των οποίων εκφράζουν συνήθως περίπου τα μεγέθη των χώρων σε εμβαδόν.
- Με το οργανόγραμμα μελετάμε τη σχέση των χώρων μεταξύ τους με κριτήριο τις ανάγκες αμοιβαίας επικοινωνίας τους.

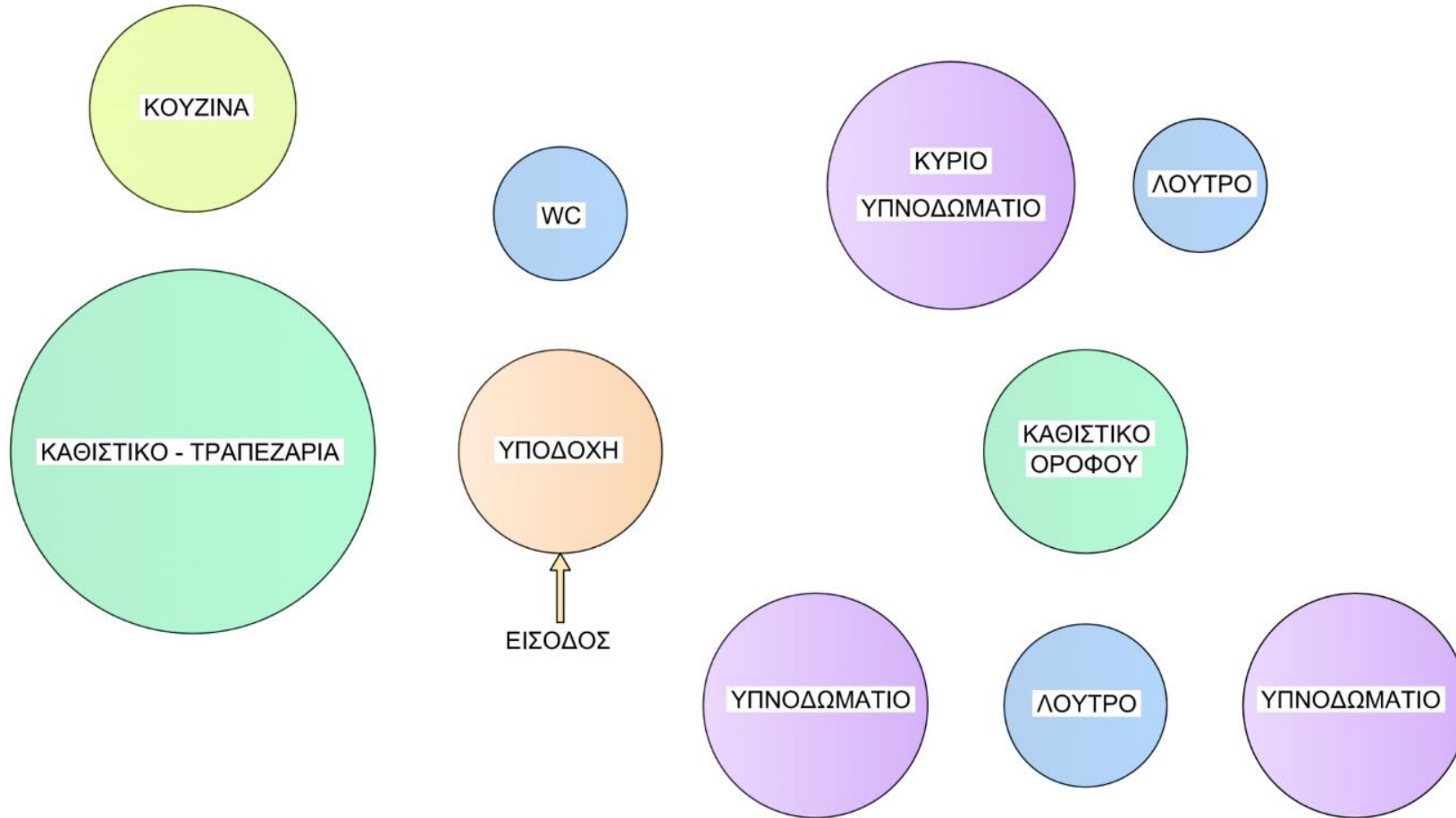

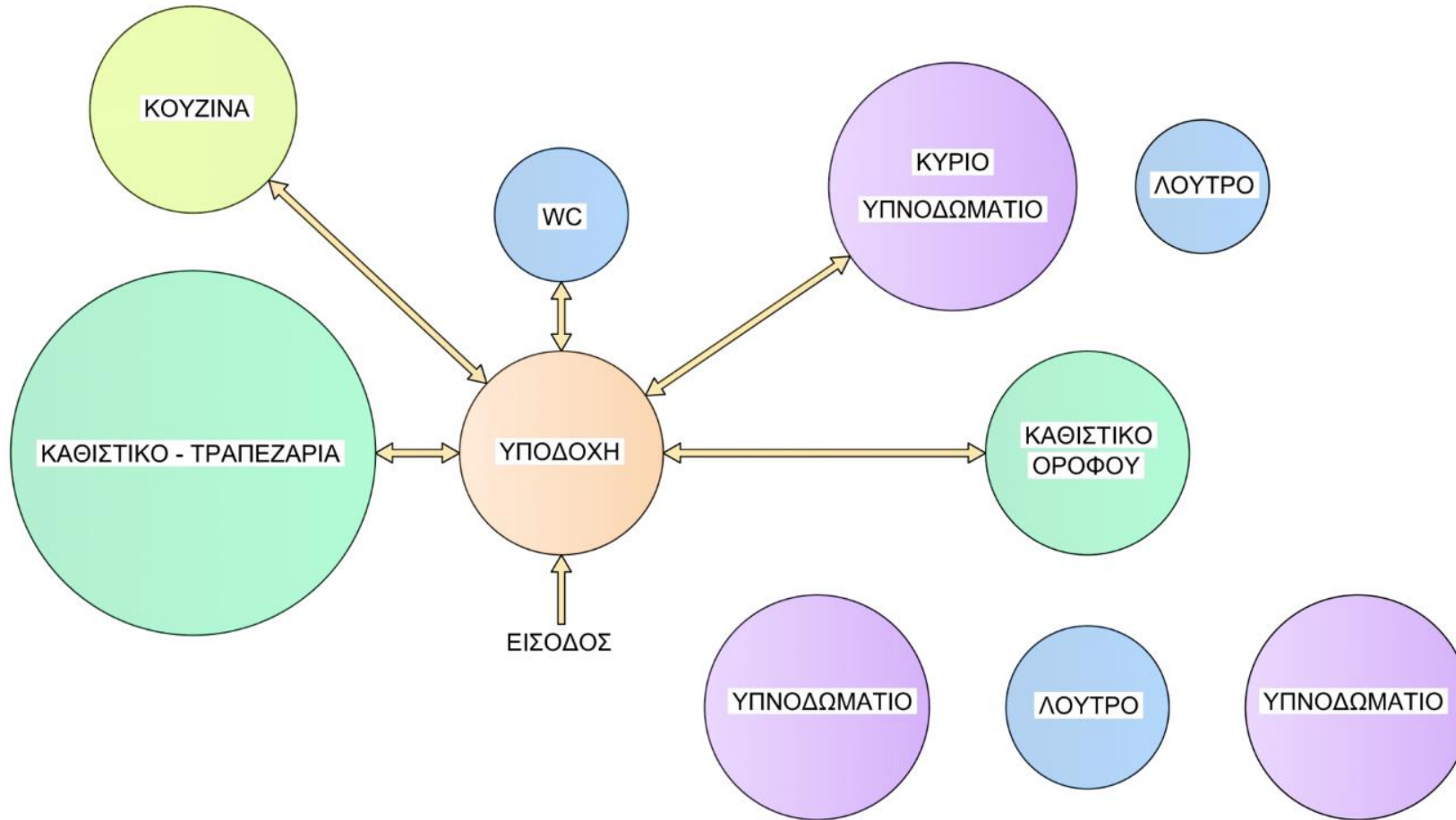

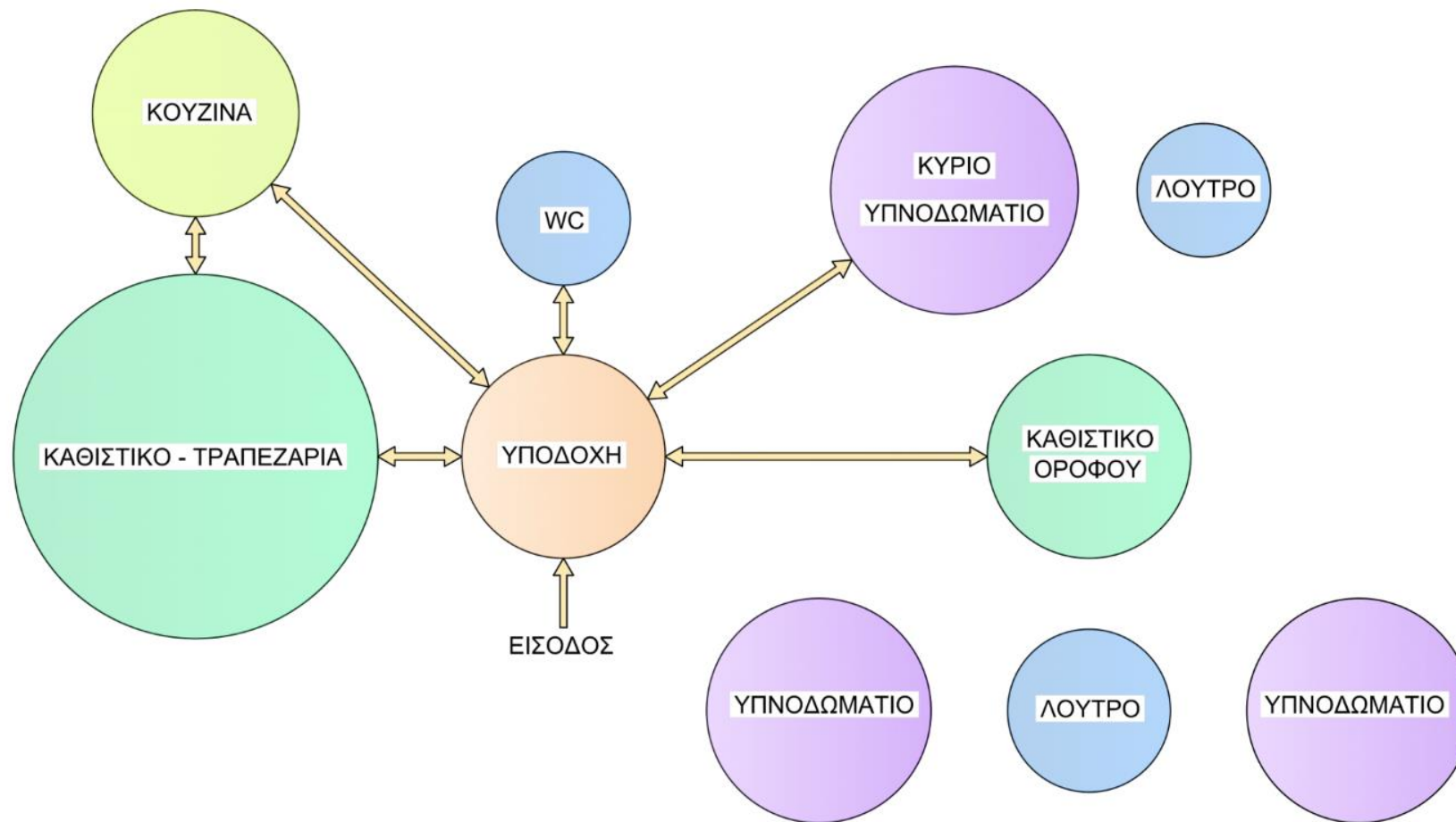

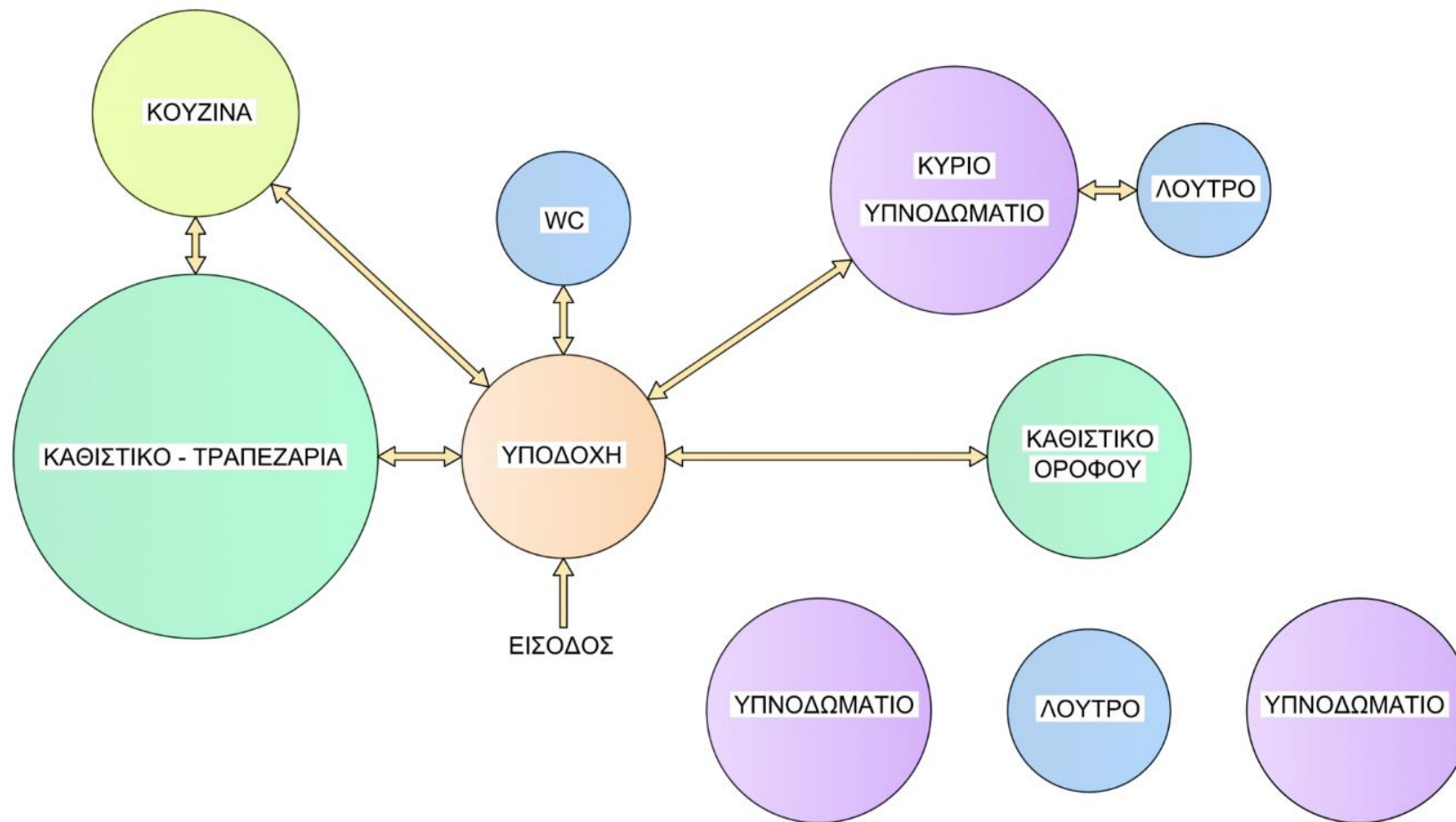

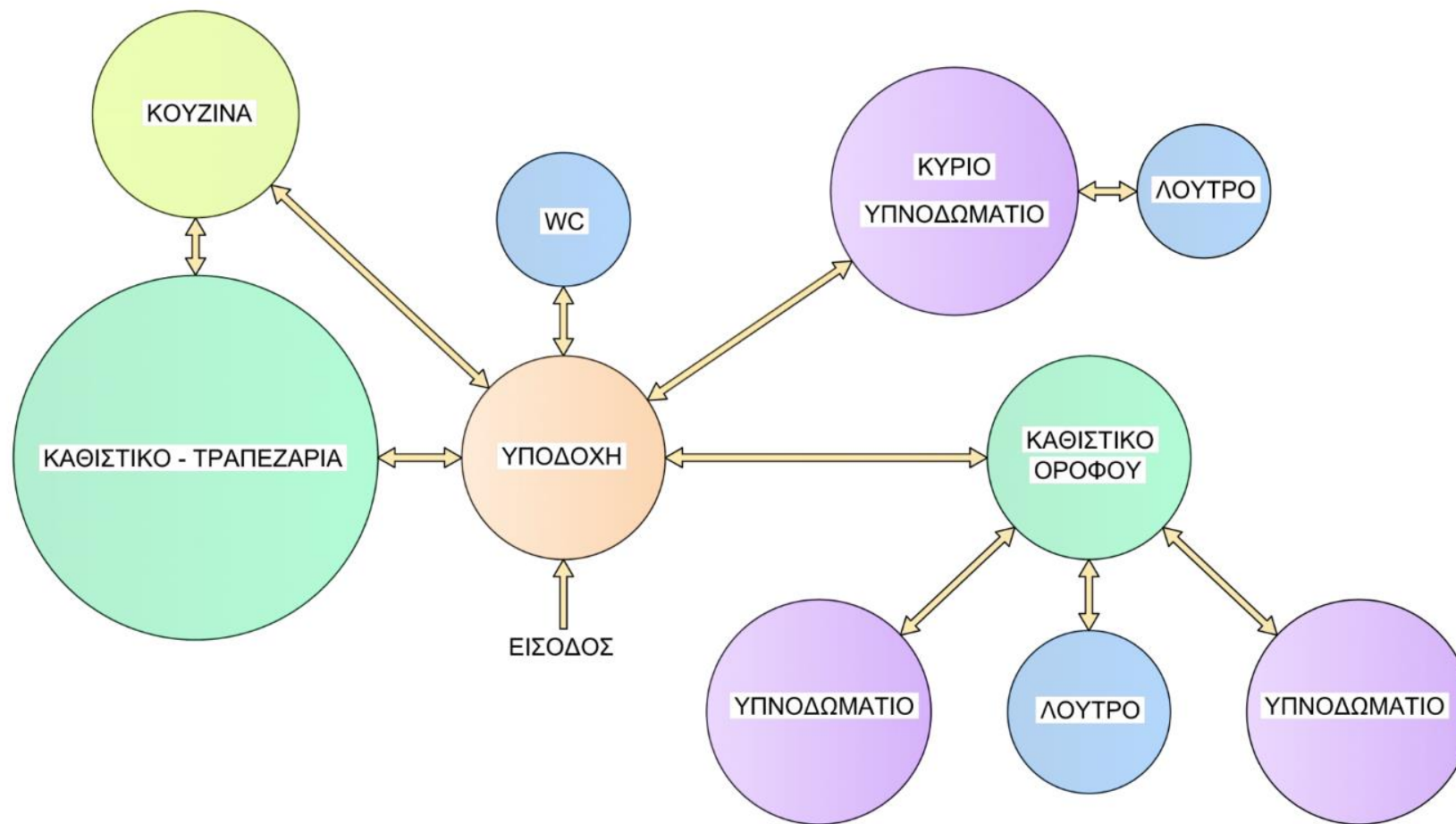

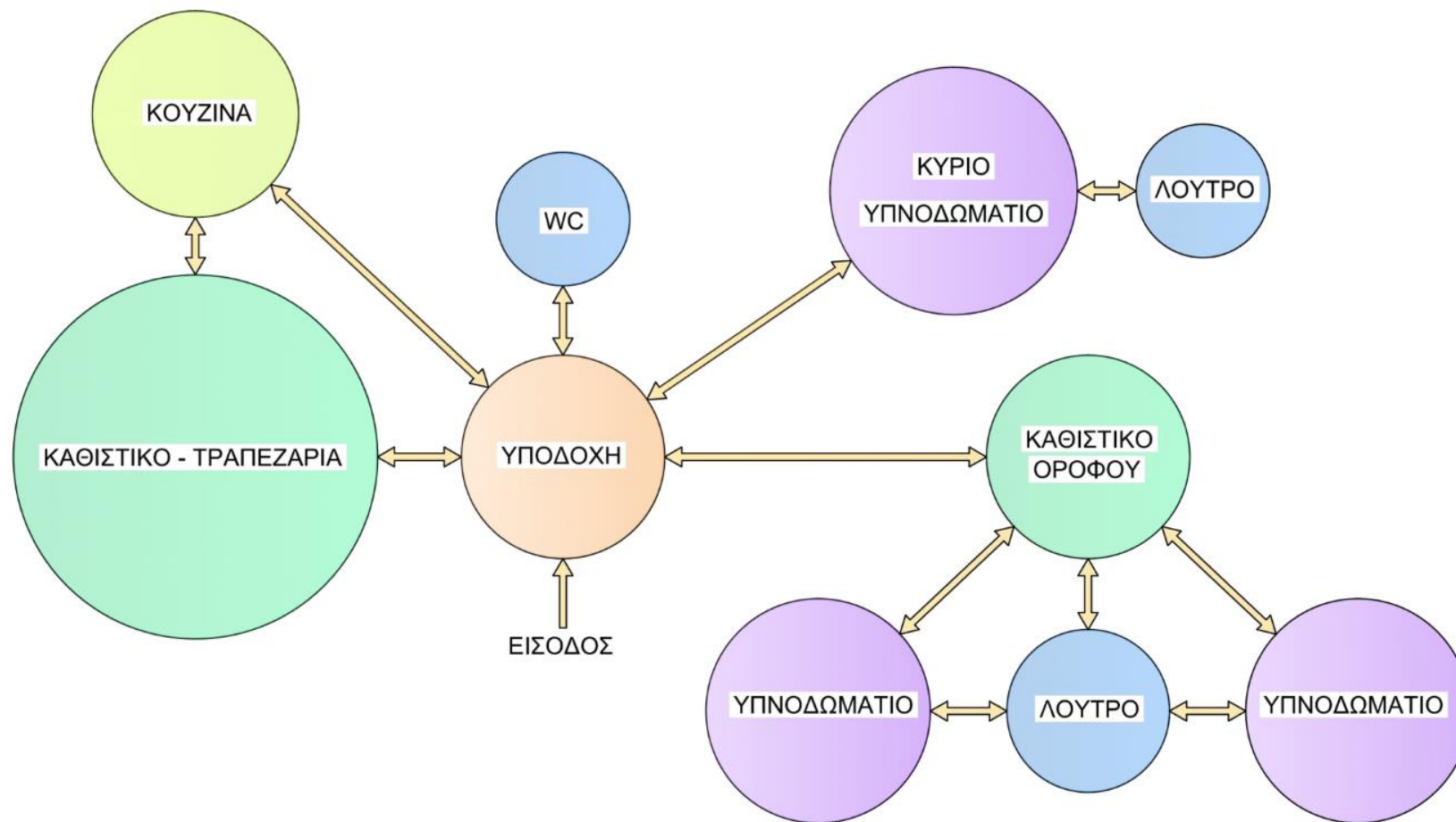

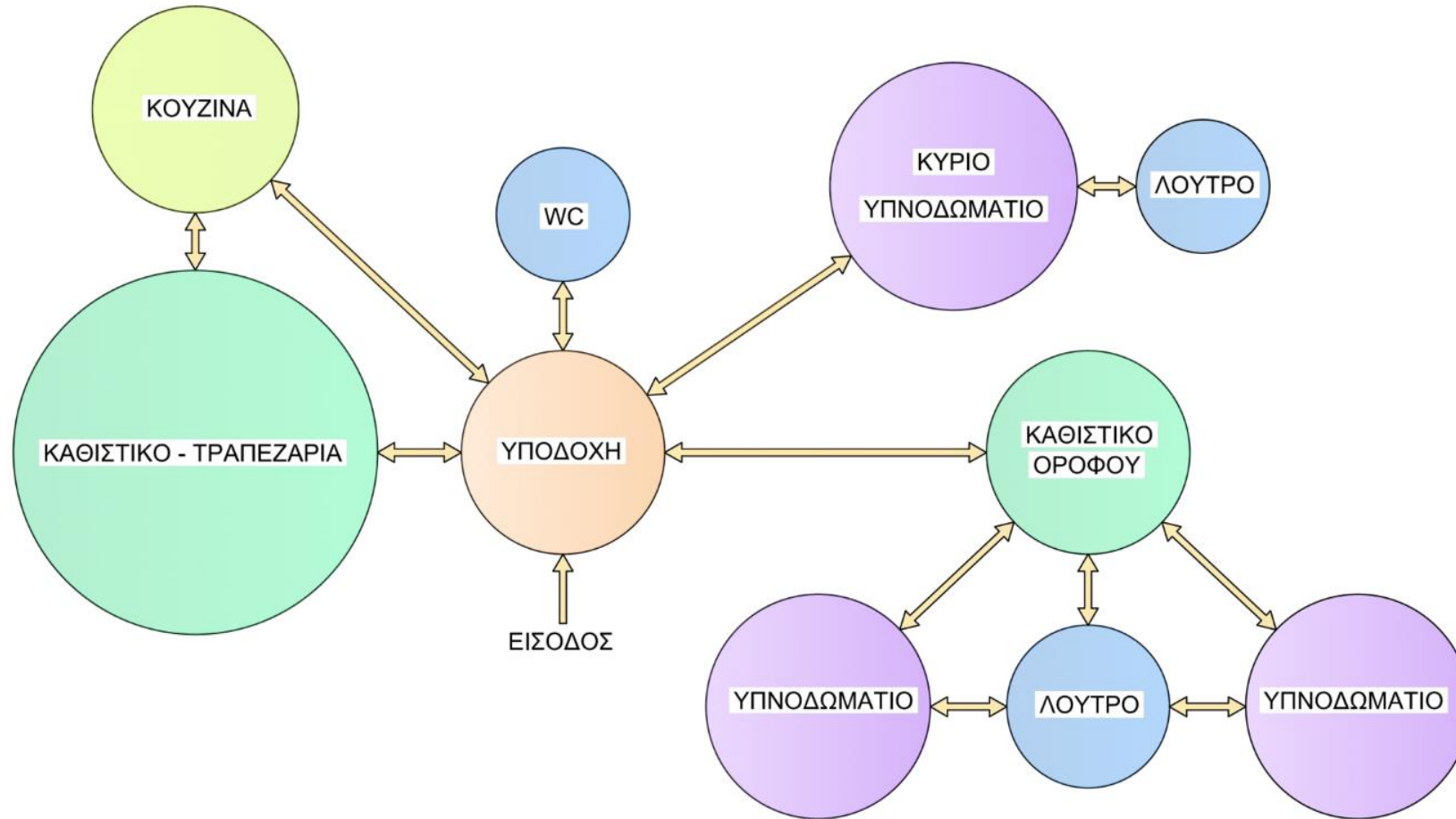

Οργανόγραμμα
(ή λειτουργικό διάγραμμα)

Τα προσχέδια

- Πρώτος στόχος στη διαμόρφωση των κατόψεων είναι να ικανοποιηθούν τα κριτήρια του κτιριολογικού προγράμματος (εμβαδά, διαστάσεις, φωτισμός, αερισμός κτλ) και του οργανογράμματος (σχέση και επικοινωνία χώρων μεταξύ τους).

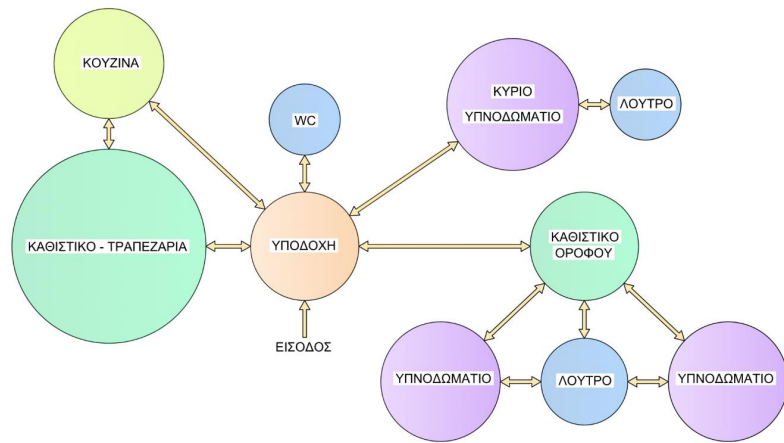

Οργανόγραμμα
(ή λειτουργικό διάγραμμα)



0 m 1 m 5 m



ΚΑΤΟΨΗ ΙΣΟΓΕΙΟΥ

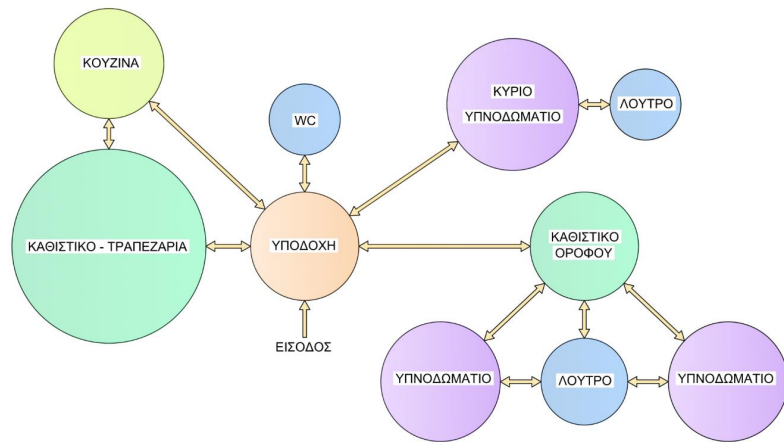

Οργανόγραμμα
(ή λειτουργικό διάγραμμα)

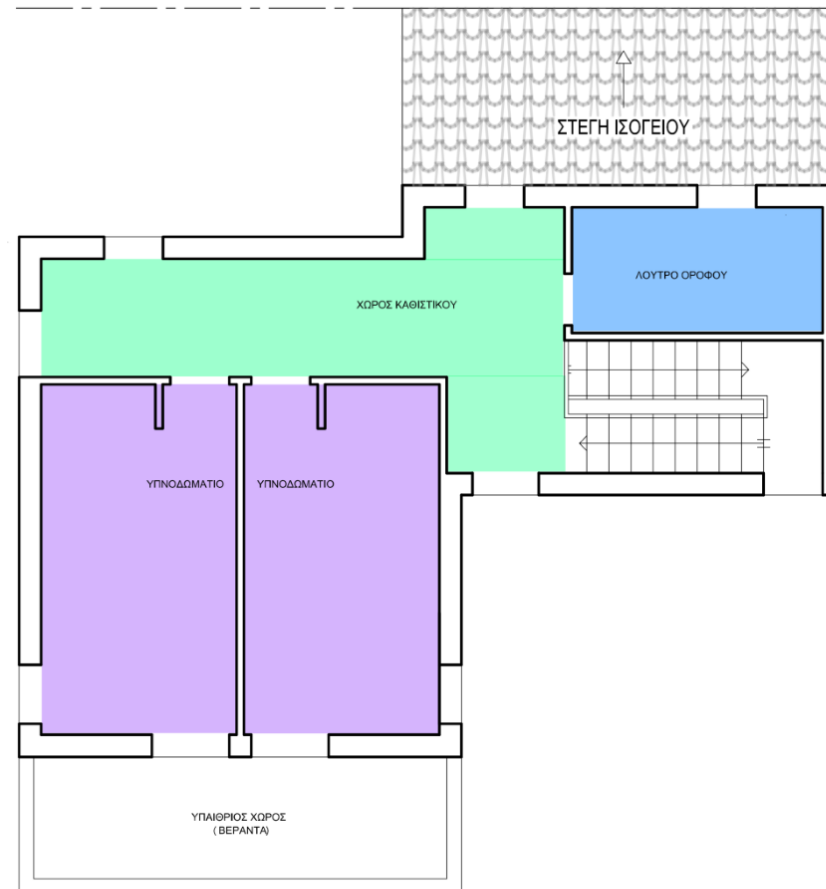

ΚΑΤΟΨΗ ΟΡΟΦΟΥ

0m 1m 5m



Παραδείγματα και είδη οργανογραμμάτων

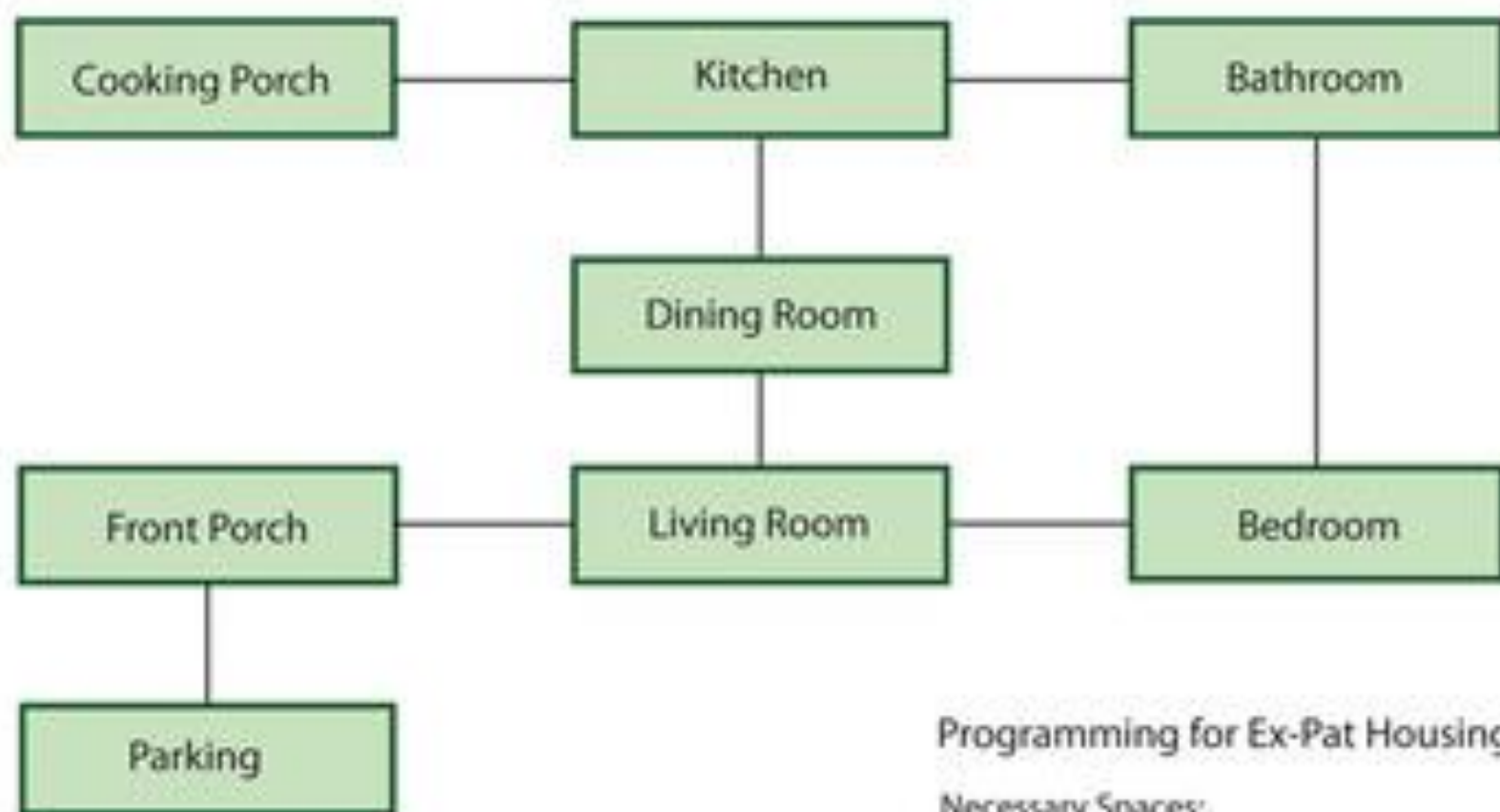

Programming for Ex-Pat Housing

Necessary Spaces:

- Porch
- Kitchen
- Living Room
- Dining Area
- Bedrooms (2-4)
- Bathrooms (1-2)
- Outdoor Cooking Area
- Parking

PROGRAM DIAGRAM

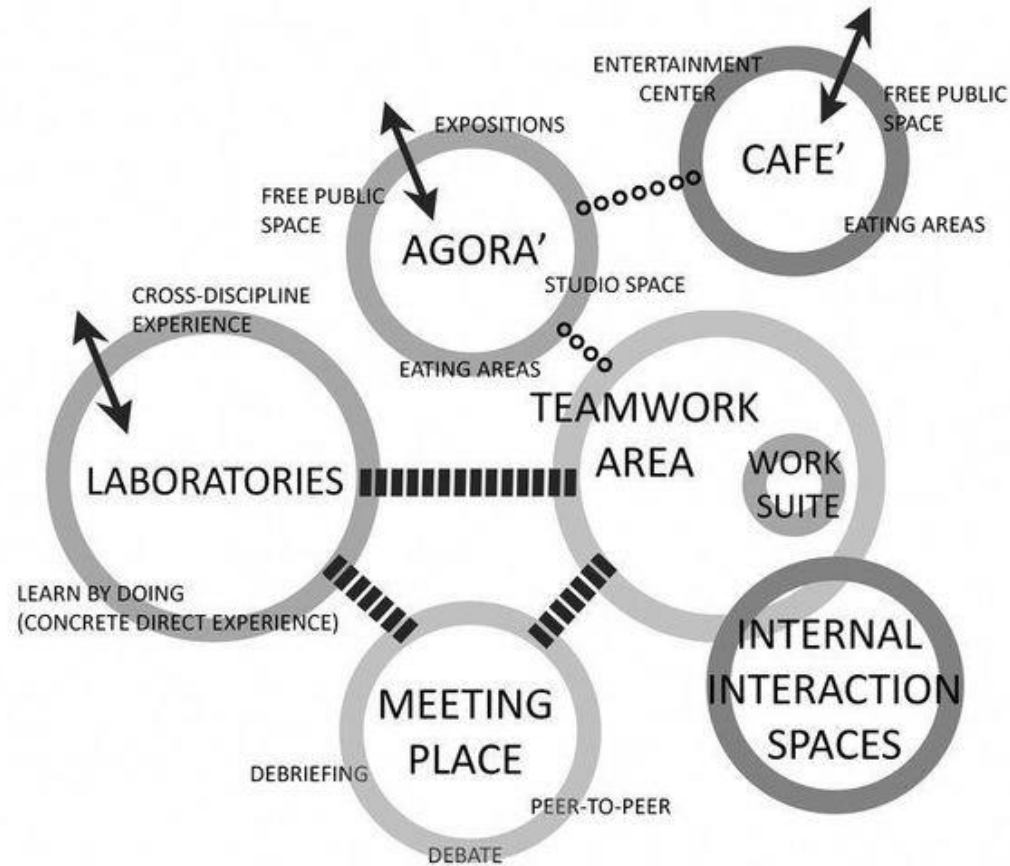

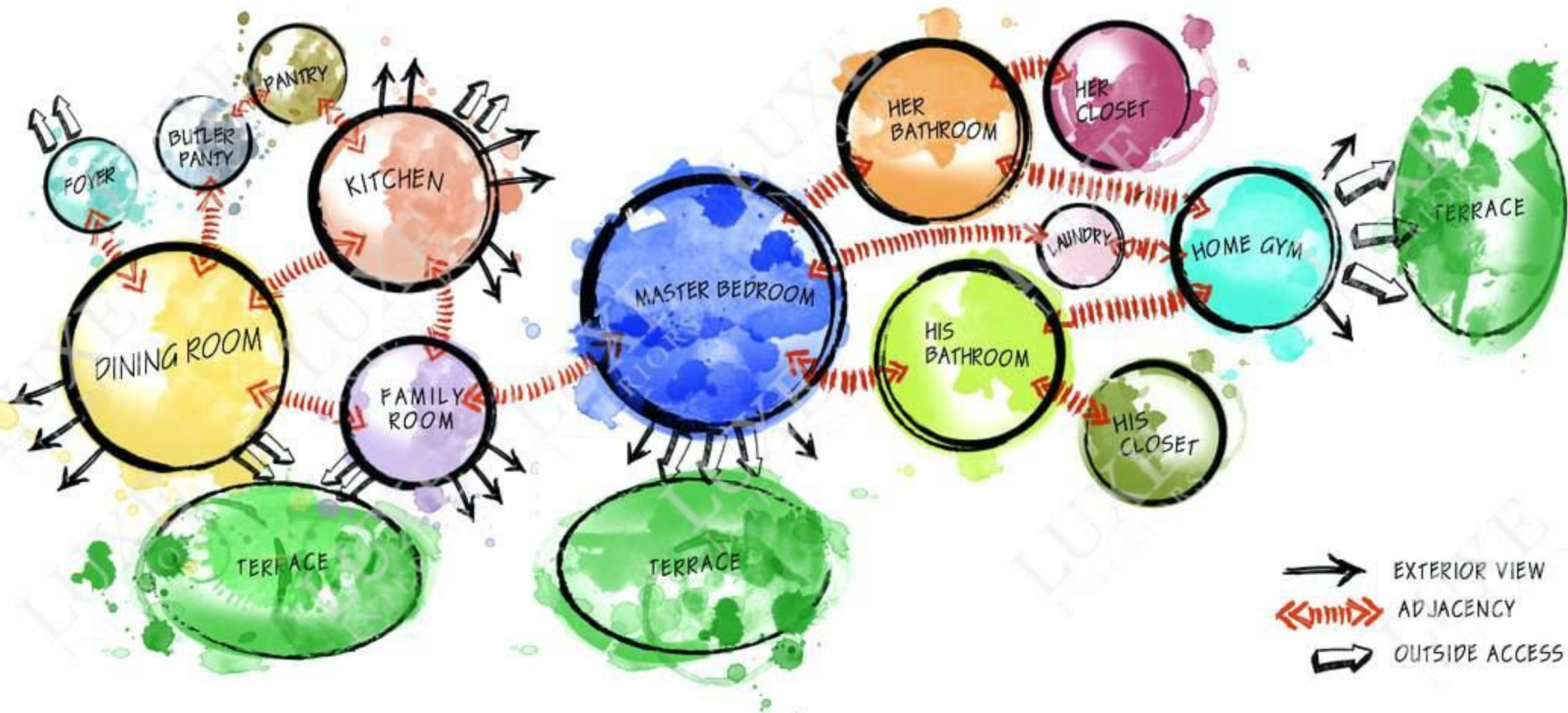

- THE FIRST STEP OF DESIGN PROCESS.
- THE BEGINNING POINT OF THE GRAPHIC DEVELOPMENT OF A DESIGN.

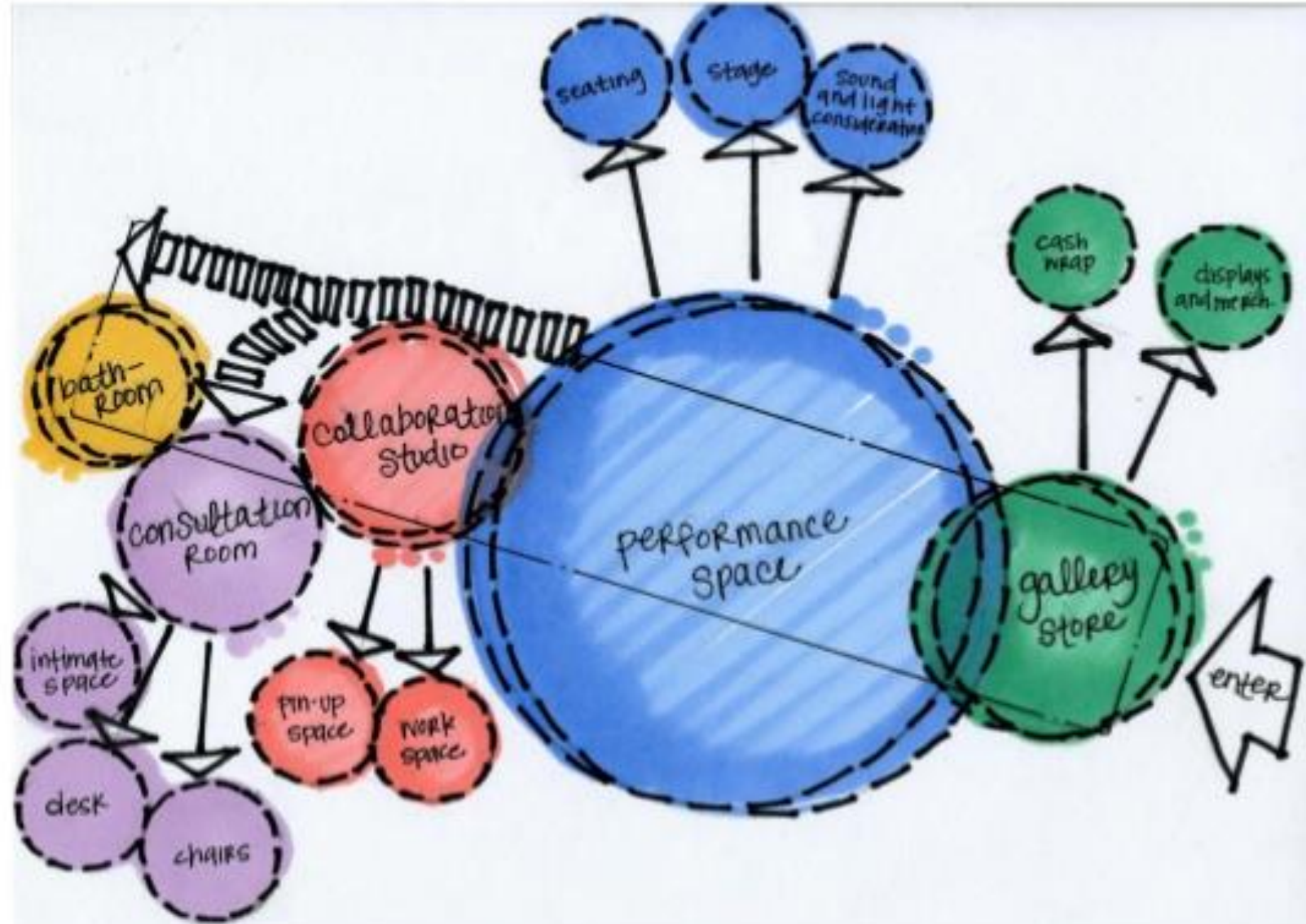

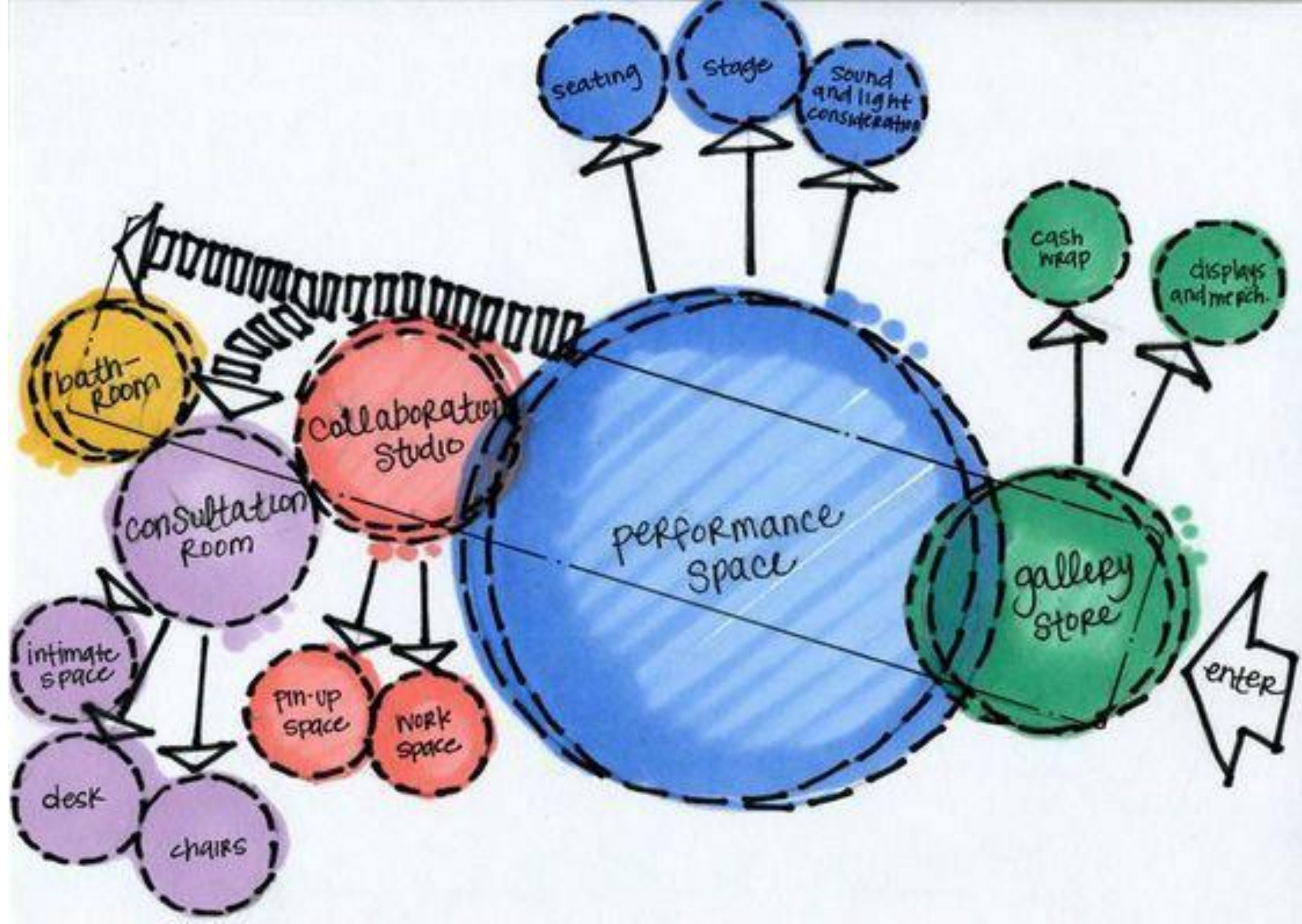

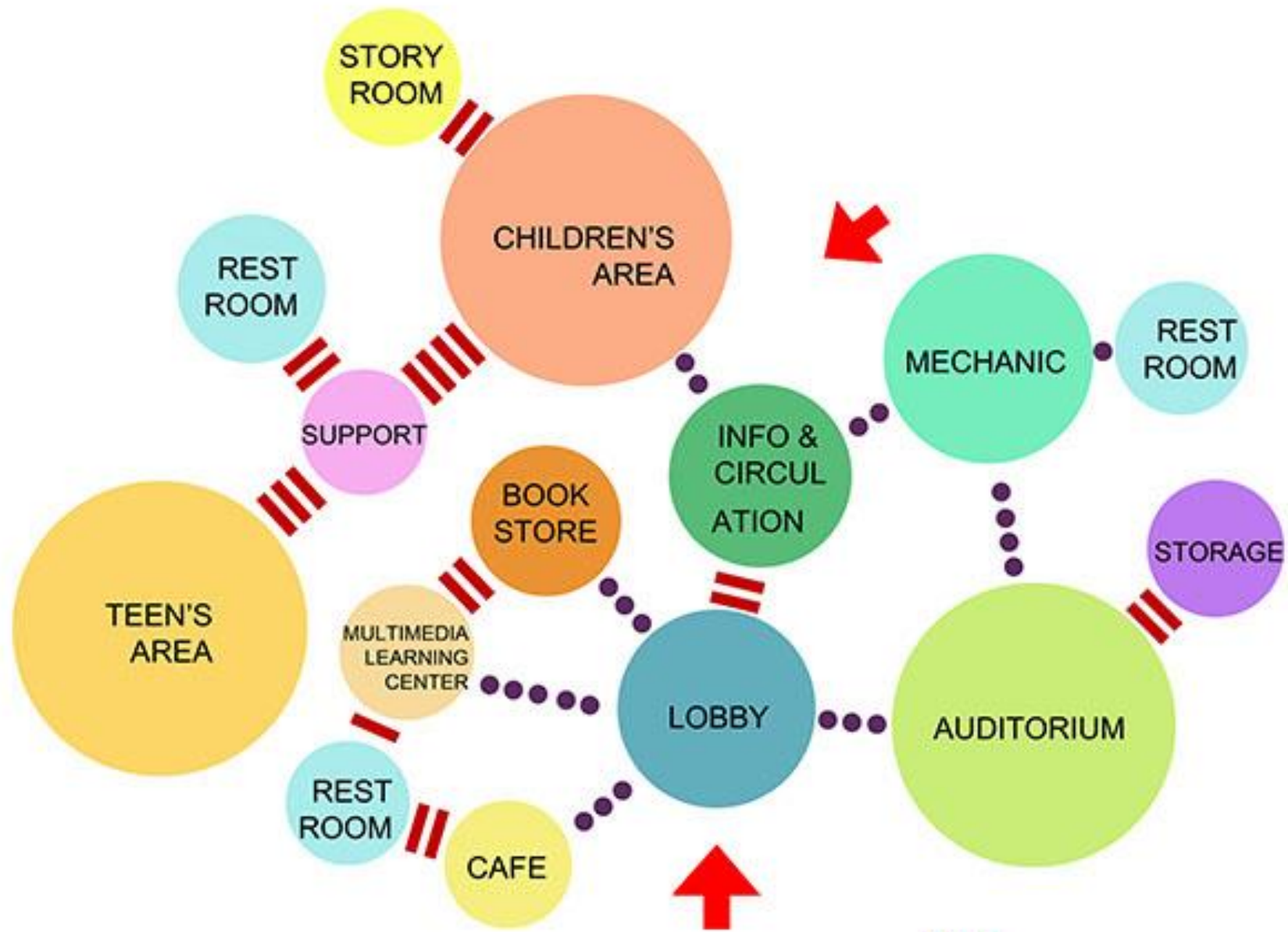

-  Major Adjacency
-  Minor Adjacency
-  Entry

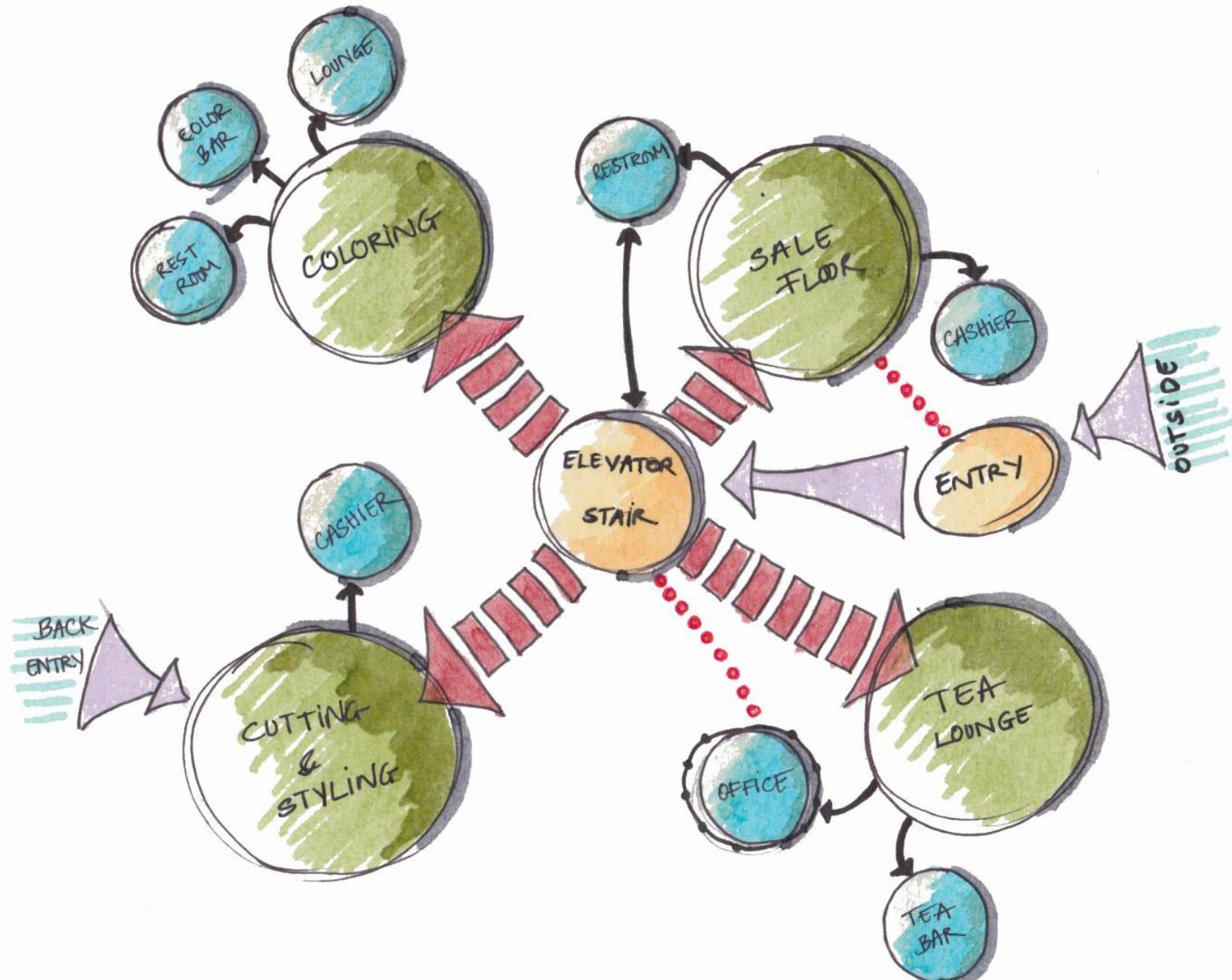

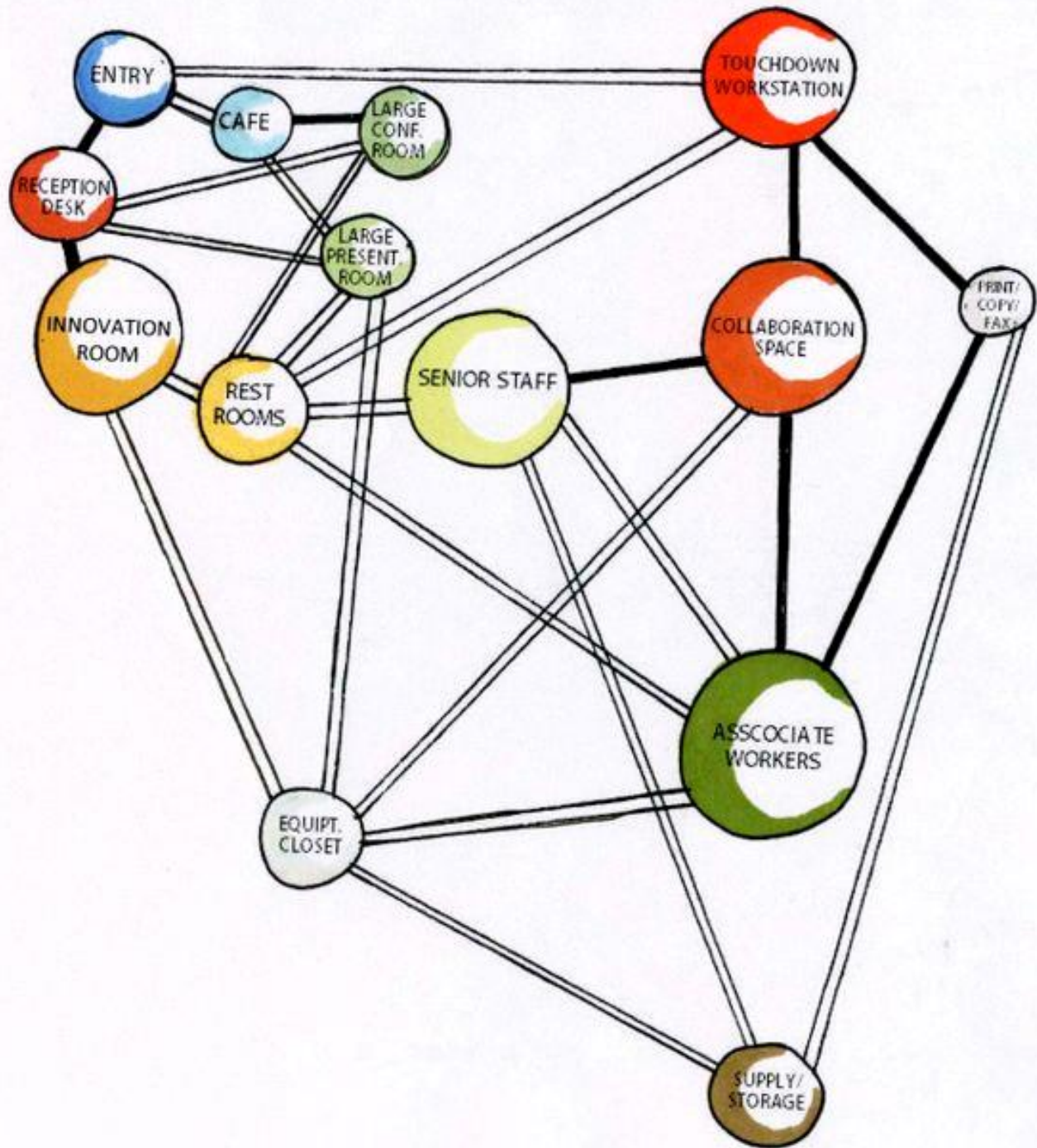

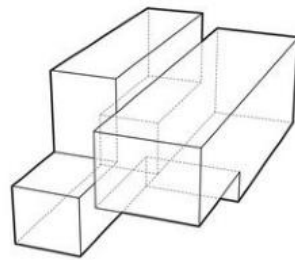
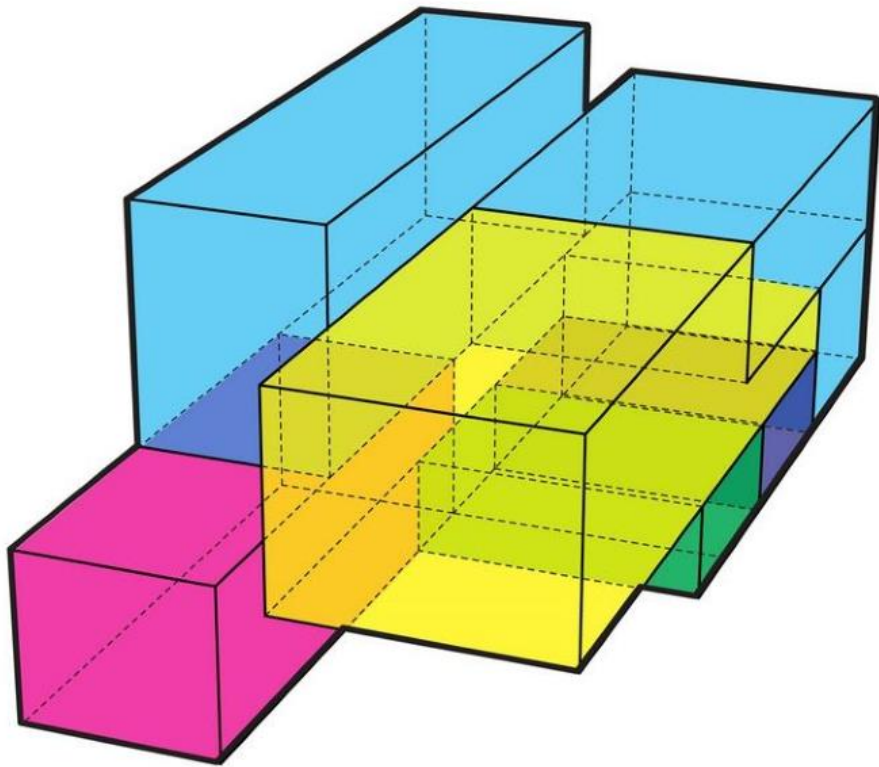

base drawing

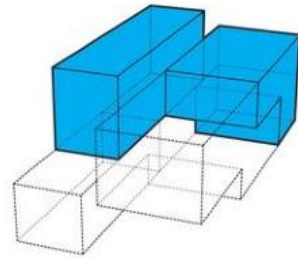

bicycle storage

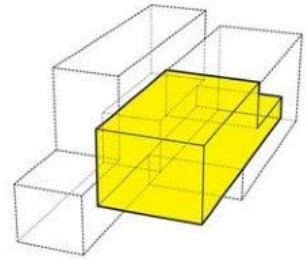

bicycle repair shop

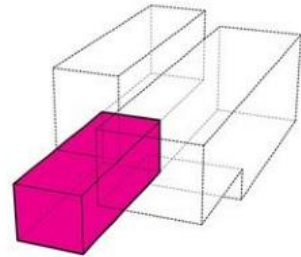

cafe

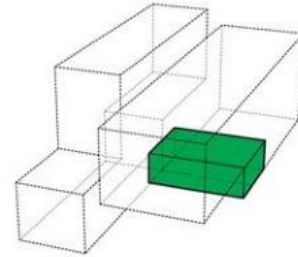

locker rooms

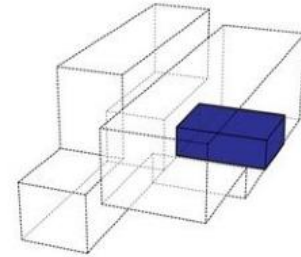

restrooms

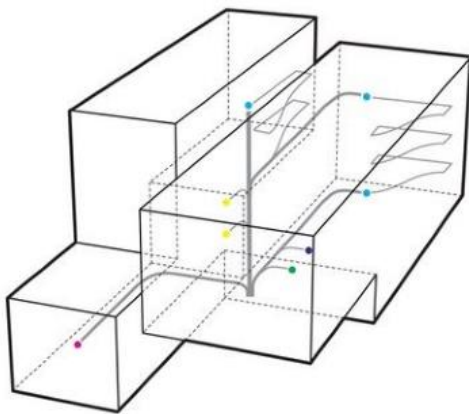

interior circulation

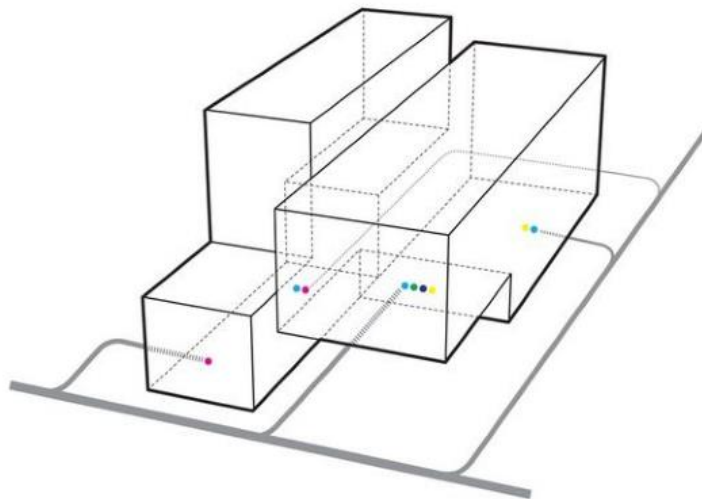

exterior circulation

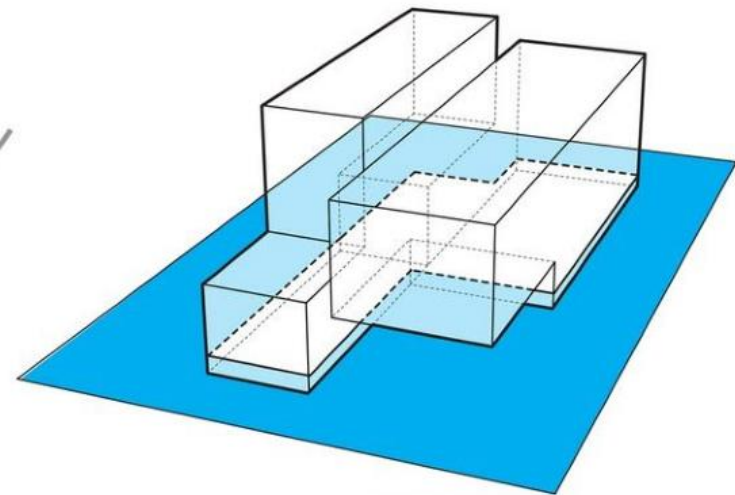

relationship to groundplane

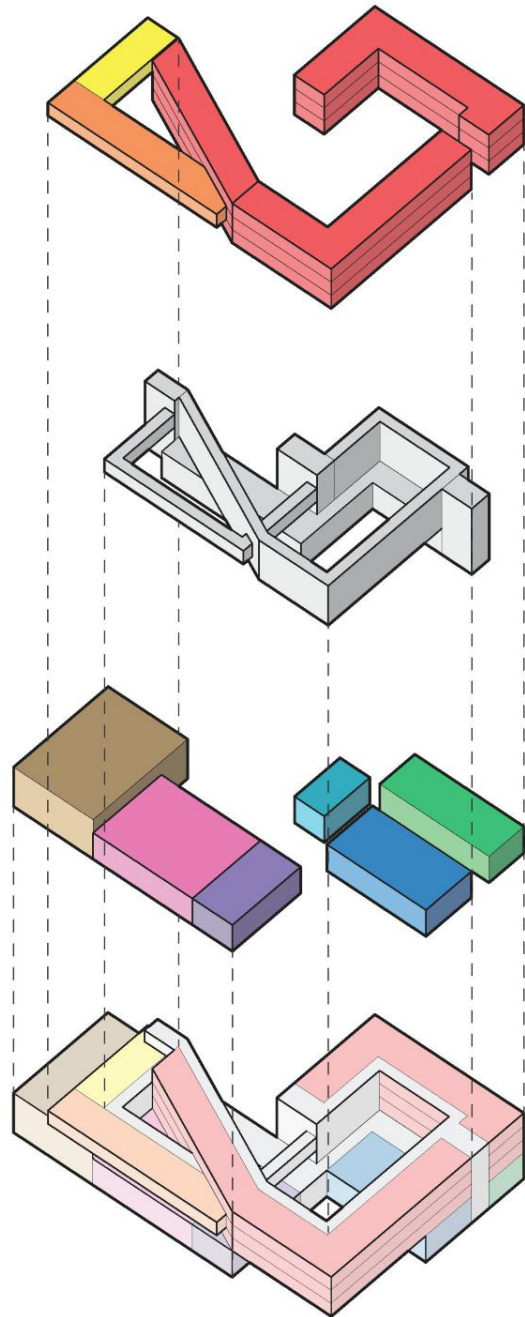

■ Classrooms / Labs / Homerooms

■ Art Studios

■ Music Rooms

■ Circulation Paths

■ Auditorium

■ Gymnasium

■ Administration / Health Center

■ Cafeteria

■ Kitchen

■ Library / Study Lounge

Program Axonometric

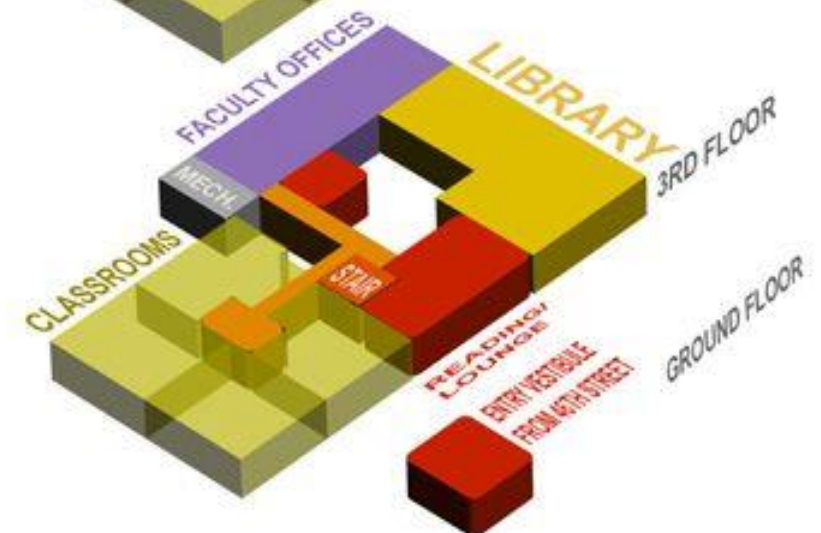
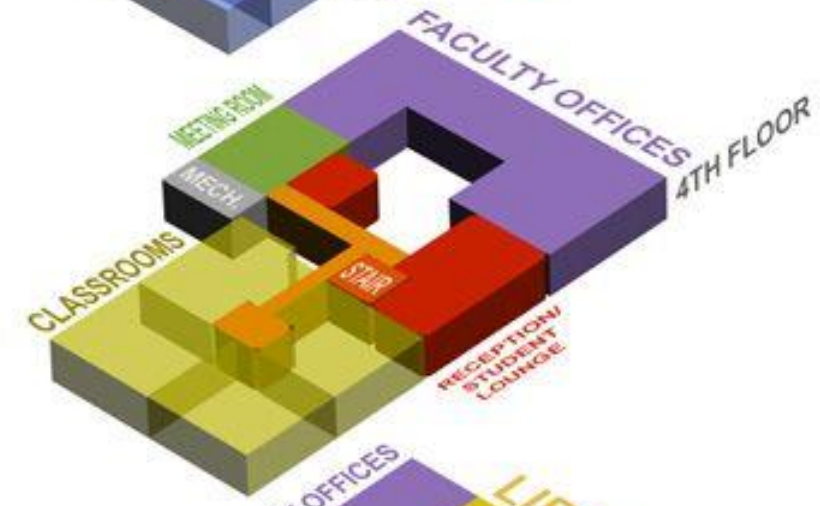
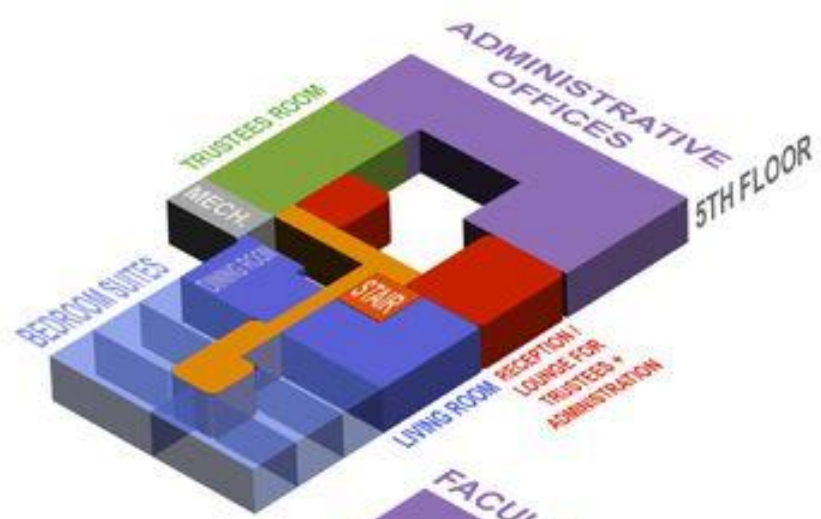



STRUCTURE

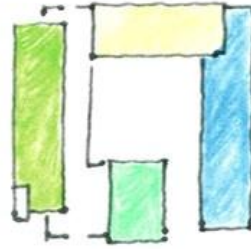

PROGRAM

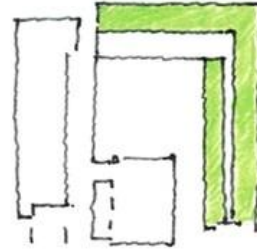

PRIVACY



NATURE

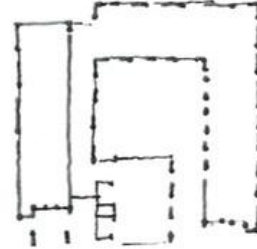

DAYLIGHTING

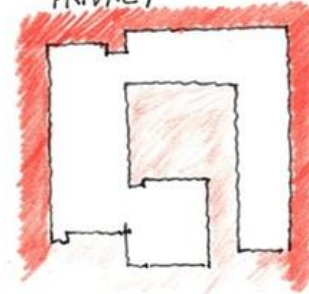

NOISE

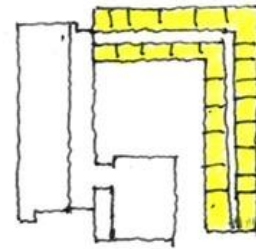

HOME (EVENING)



PUBLIC REALM

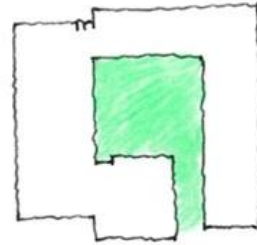

COURTYARD

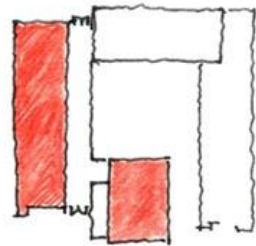

SCHOOL (DAY)

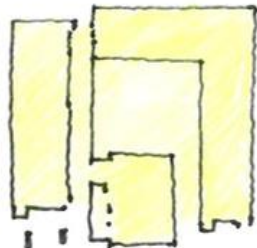

PRIVATE REALM

MASSING AND PROGRAMMING

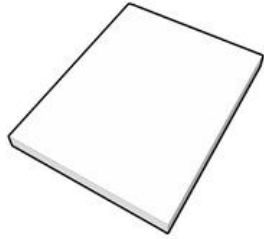

THE MASS STANDS ON THE 150 M2 SITE

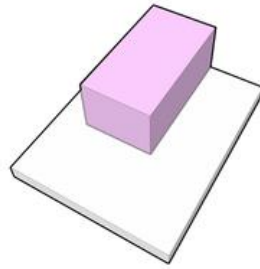

THE FIRST FLOOR FUNCTIONED MOSTLY FOR LIVING AREA WITH NO PARTITION

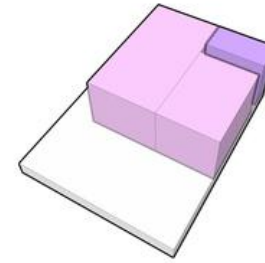

THE LIVING AREA FEELS EVEN LARGER BECAUSE IT'S CONNECTED TO THE RELAXING AREA. FOR THE OTHER FUNCTION, THERE ARE KITCHEN ON THE BACK, PANTRY AND ONE BATHROOM.

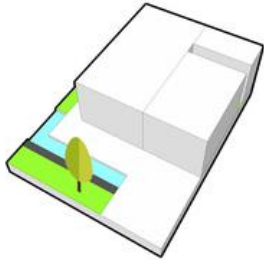

THERE ARE A COMBINATION OF GREENERY AND A POND TO CREATE A GOOD AIR CIRCULATION INSIDE THE BUILDING

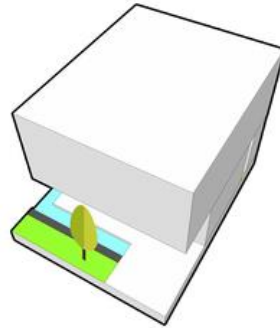

THERE IS A CANTILEVER ON THE SECOND FLOOR

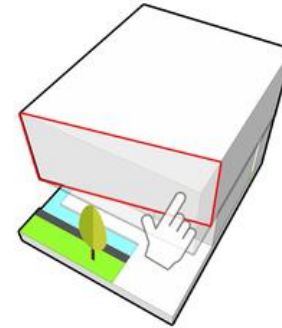

WE PUSH THE SECOND FLOOR'S FACADE BACKWARDS TO MINIMIZE THE SUN RADIATION FROM THE WEST SIDE.

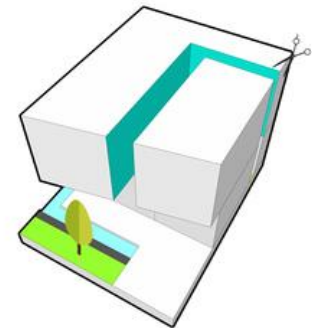

THE SECOND FLOOR MASSING WAS CUT TO CREATE A CORRIDOR AND A VOID TO OPTIMIZE THE AIR CIRCULATION.

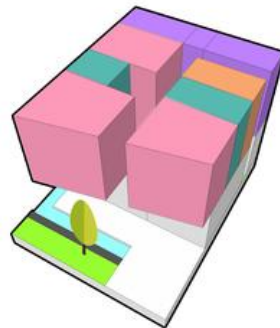

THE SECOND FLOOR FUNCTIONED FOR BEDROOM AREA AND A SERVICE AREA ON THE BACK.

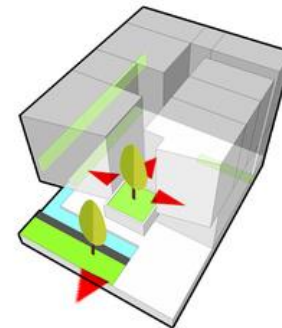

FOR THE GREENERY, WE ADD A FLOATING GARDEN THAT CAN BE SEEN FROM 4 SIDES.

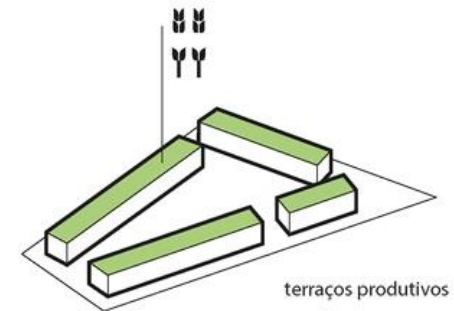
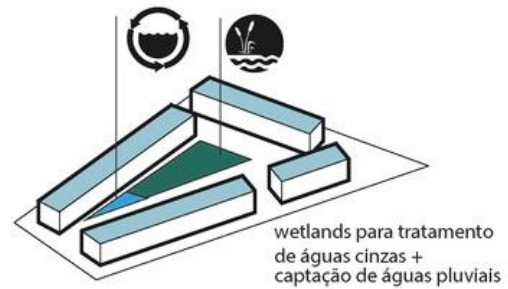
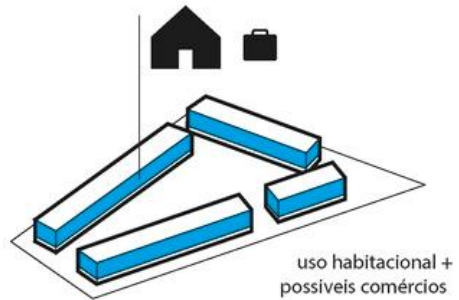
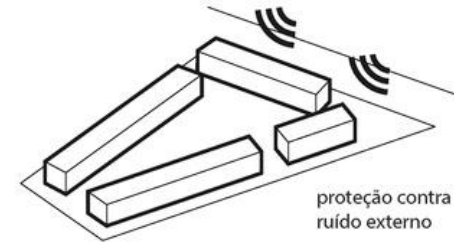
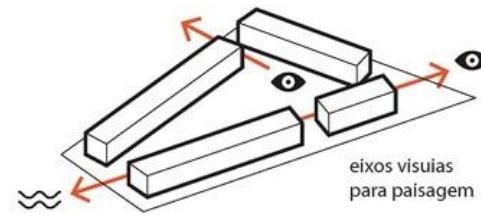
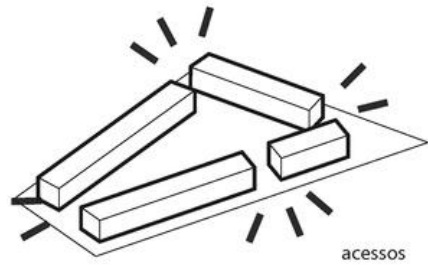
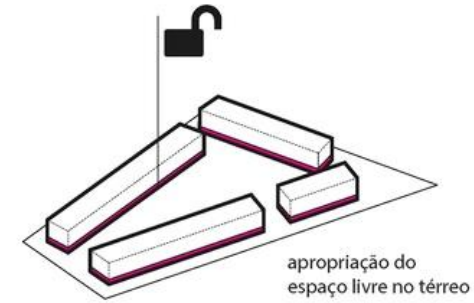
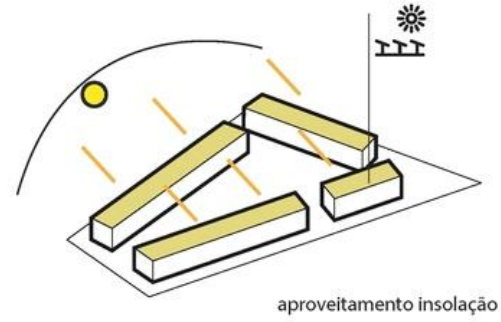
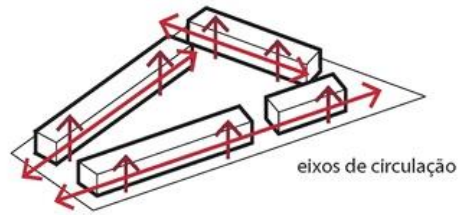
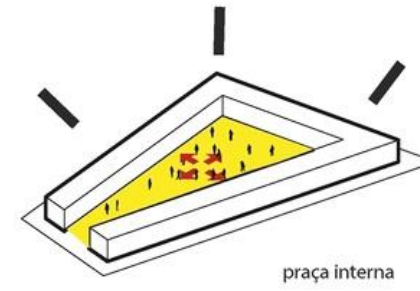
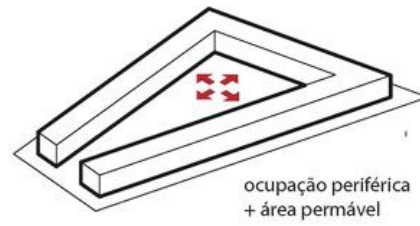
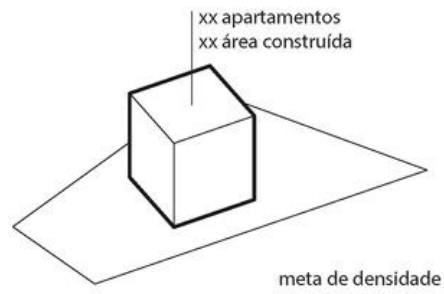

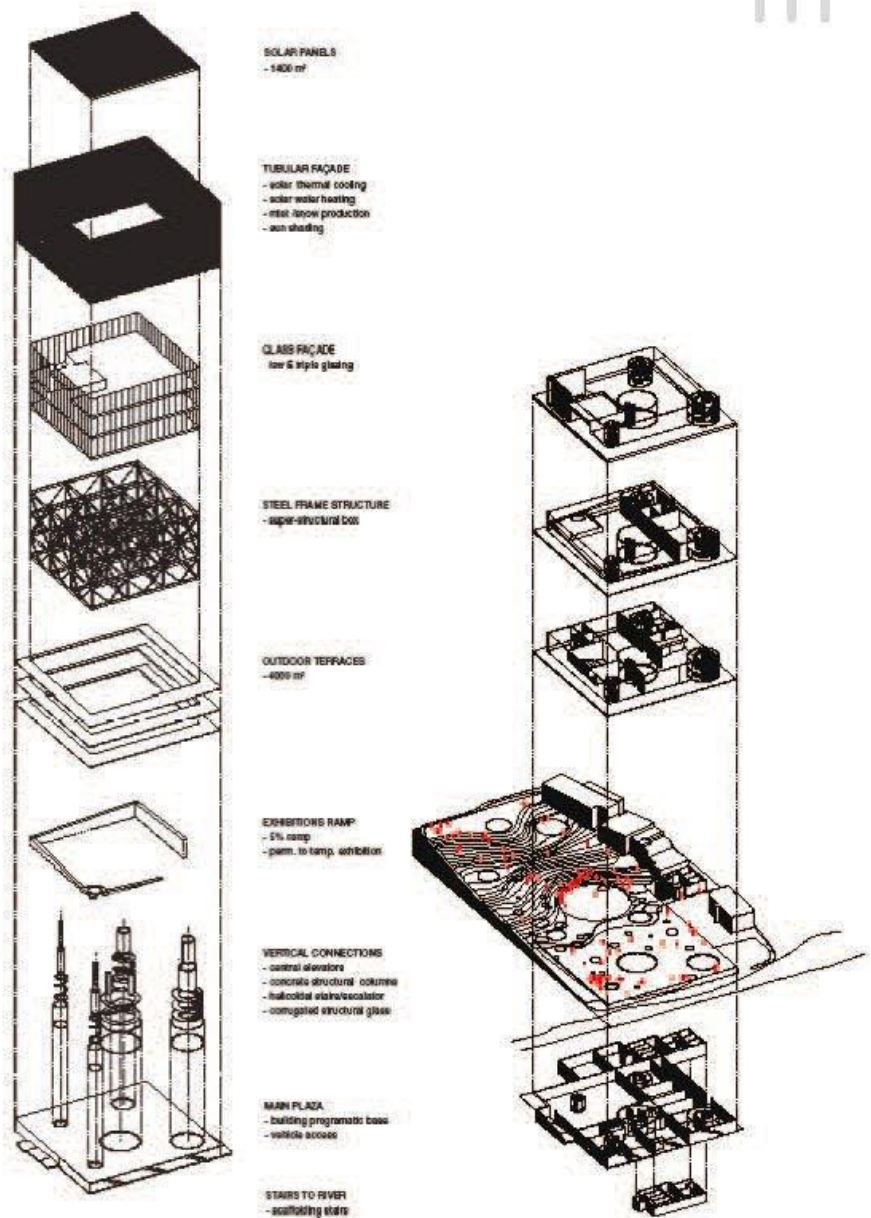
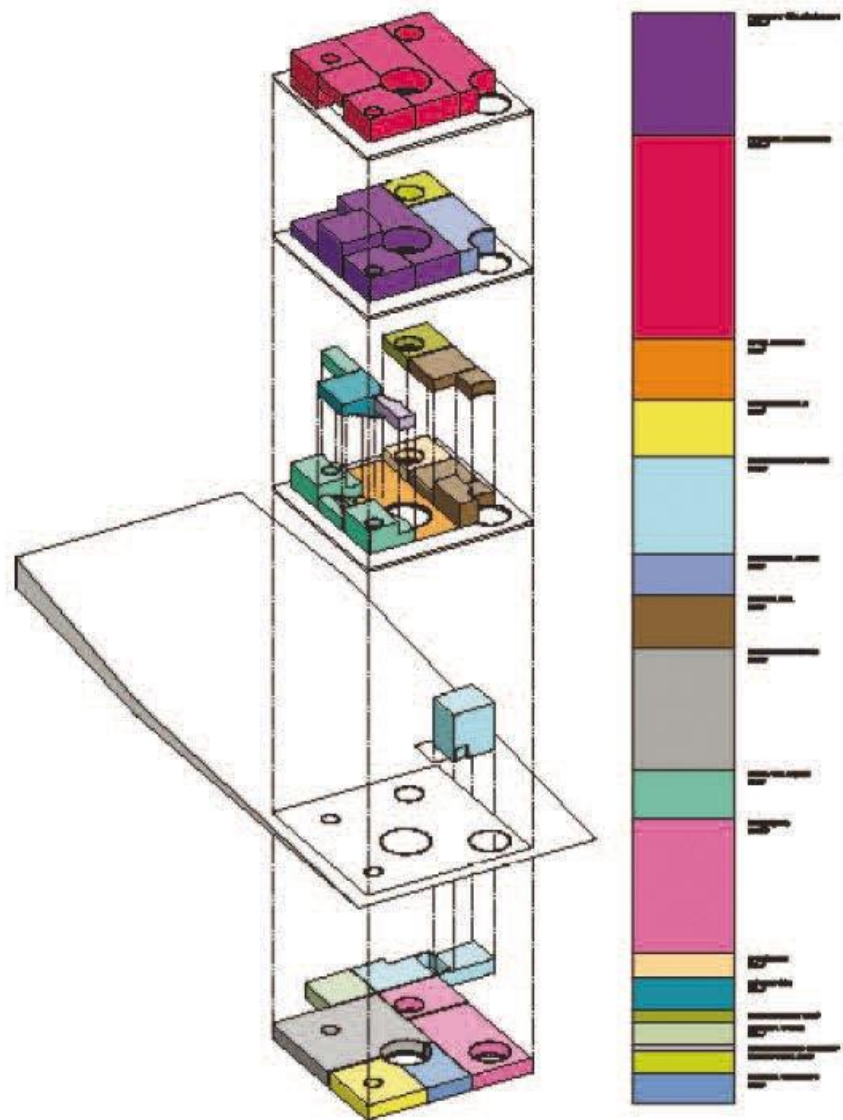

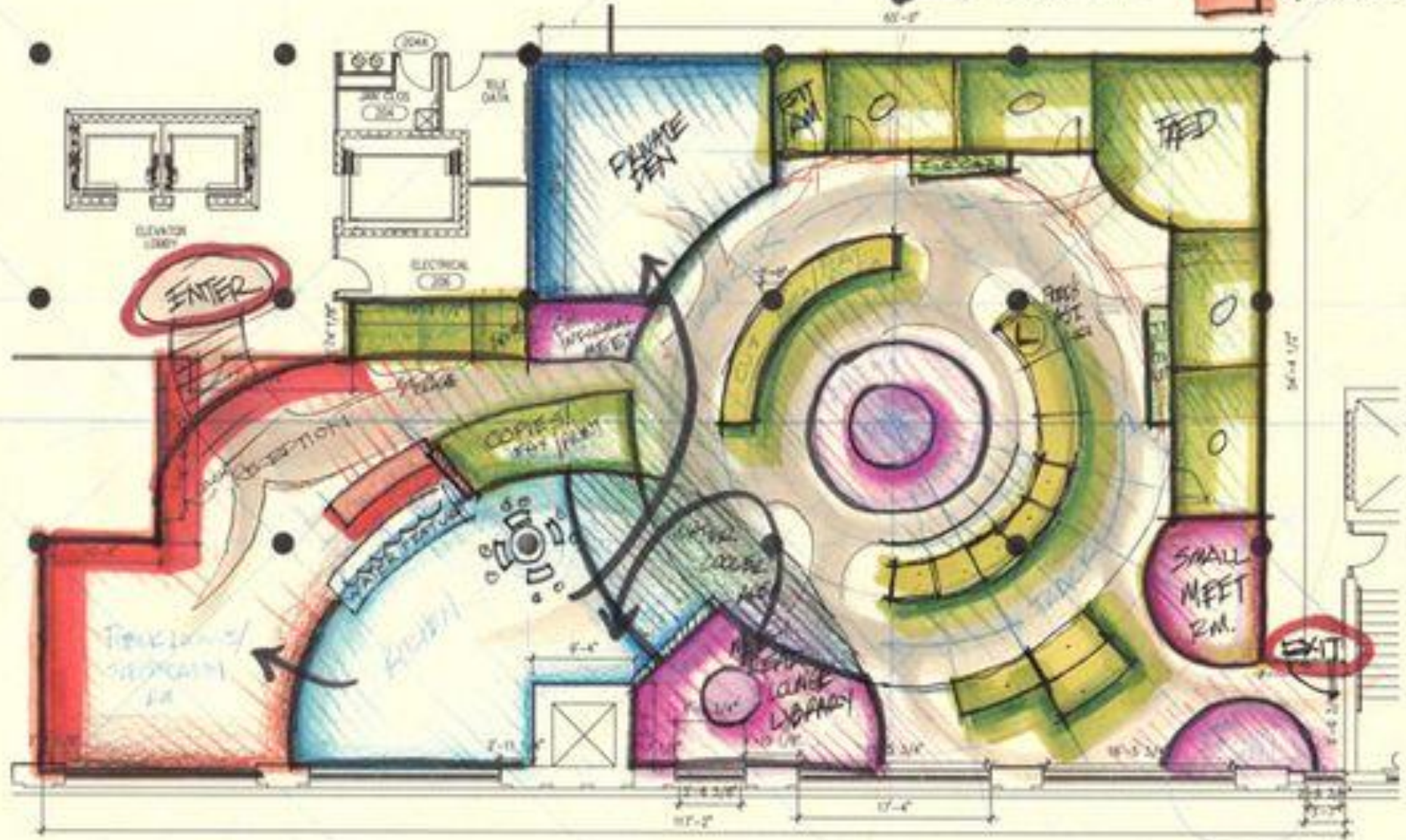

- = SEMI-MEETING
- = WORK
- = EMPLOYEE GATHERING
- = CIRCULATION
- = PUBLIC



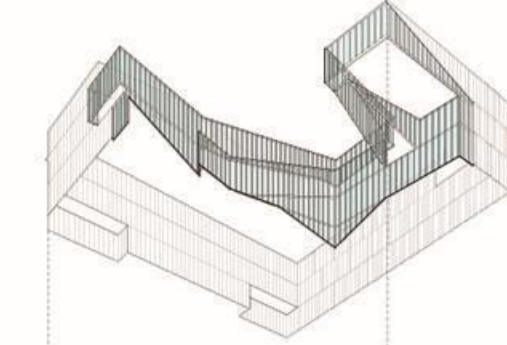

SKIN

-  *glass curtain wall*
-  *metal panel*



CIRCULATION

-  *primary route*
-  *secondary route*

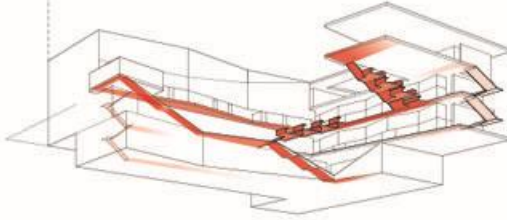

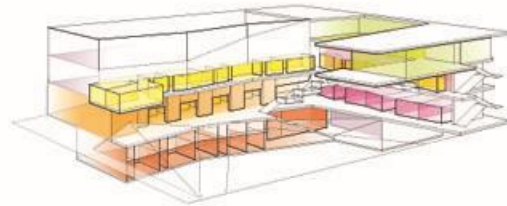

RESEARCH & COLLABORATION

-  *forum space*
-  *offices*
-  *cleanroom*
-  *characterization*
-  *general laboratories*
-  *MEP*



LANDSCAPE

-  *green roof*
-  *campus landscape*

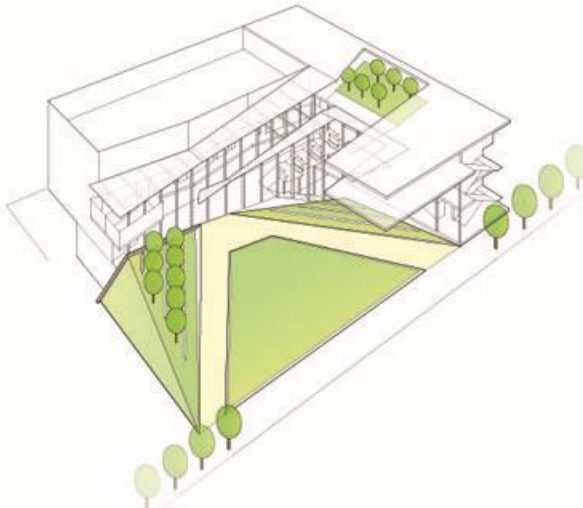

VOLUMEN INICIAL
MODULACION

PREFIGURACION

ESQUEMA
FINAL

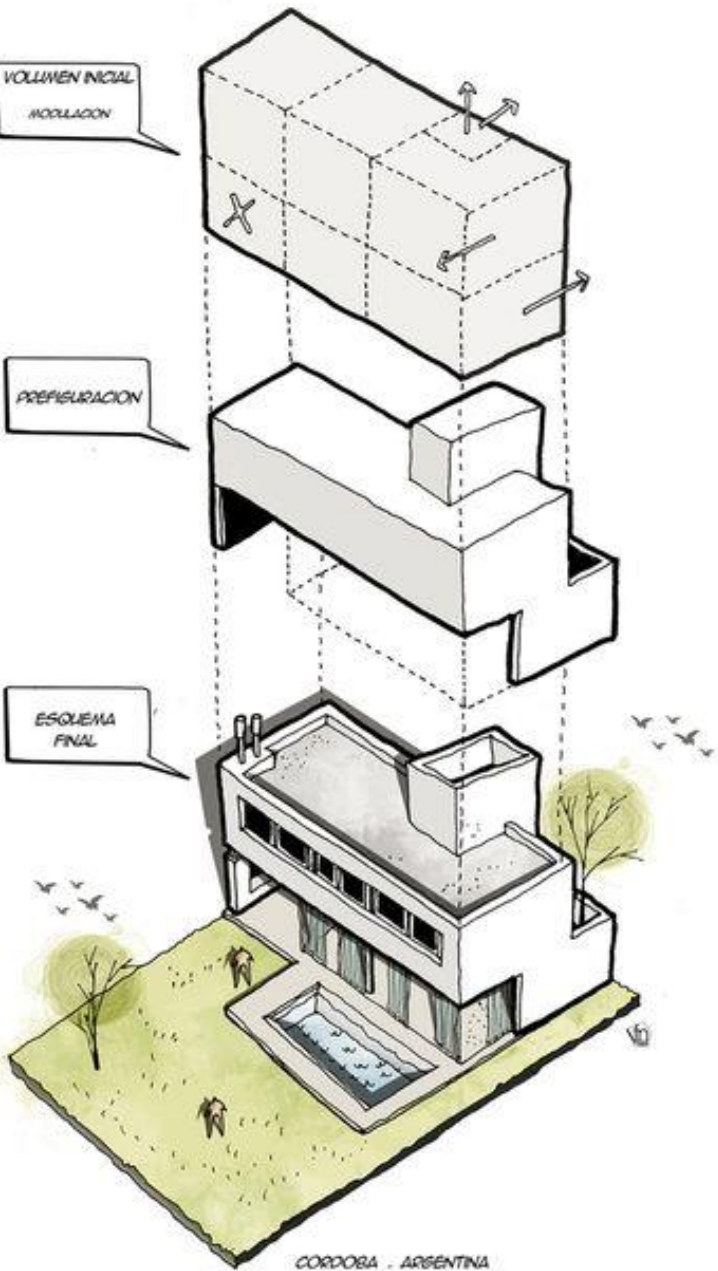

CORDOBA - ARGENTINA

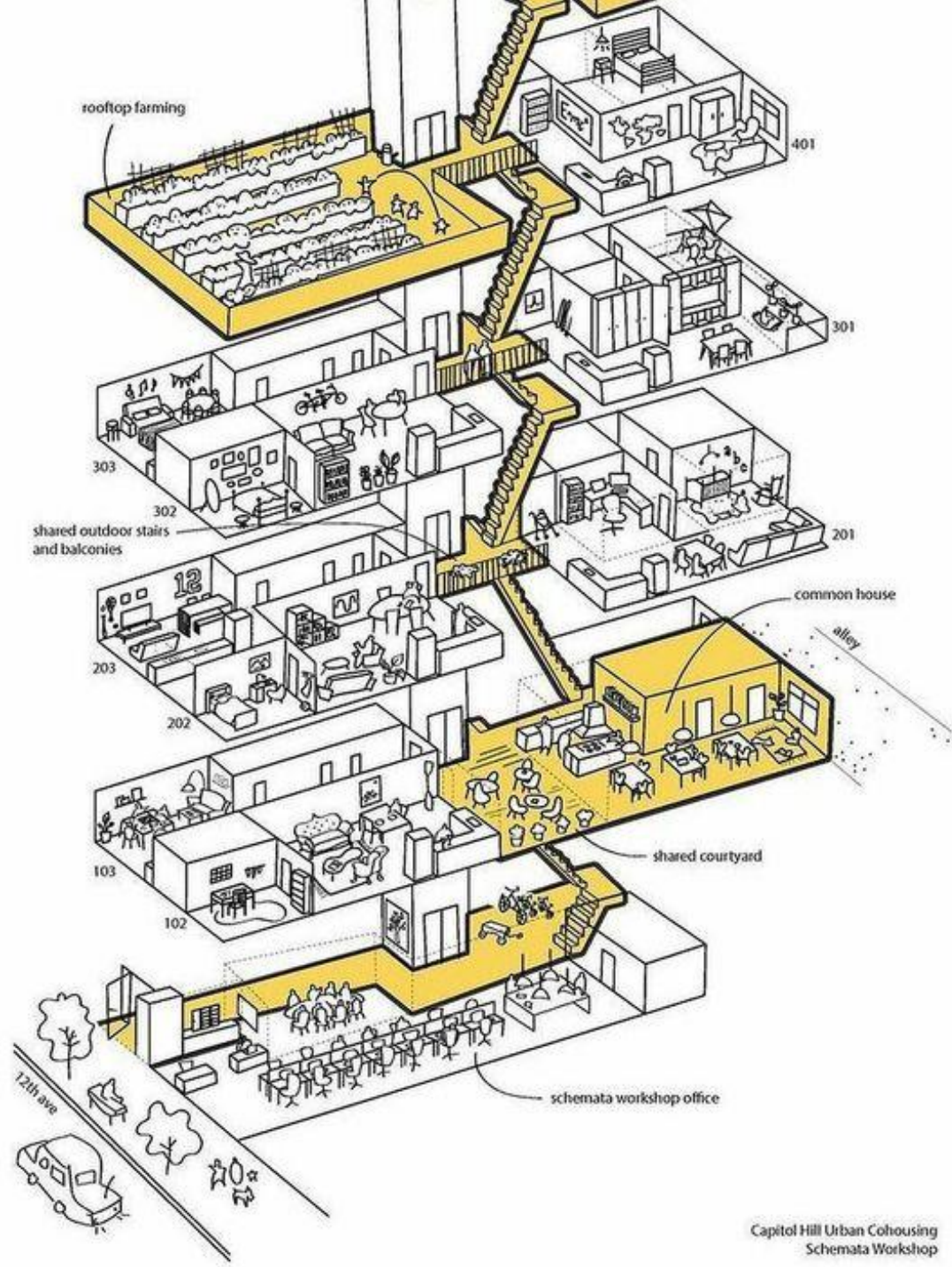

Capitol Hill Urban Cohousing Schemata Workshop